

# FLOW-THROUGH HOUSING AD 94

06/04

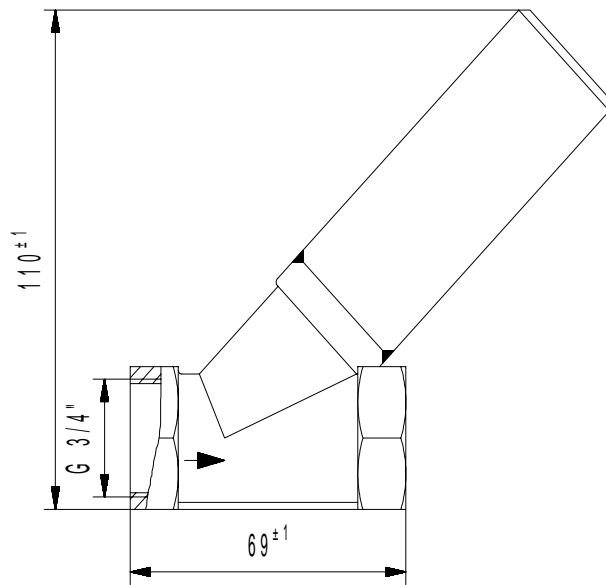

Dimensions: mm

The bevel seat flow-throw housing AD 94 is specifically conceived for installation of a pH or redox combination electrode or a conductivity cell in a pipe. The AD 94 made of stainless steel features application in process chemistry, food and pharma industry as well as for drinking water and clean water production. Use AD 94 in connection with electrodes and cells in standard dimensions (stem diameter 12 mm; immersion length 120 mm) equipped with a PG 13.5 threaded plug head for direct insertion of the electrode or sensor into the housing.

## Specifications

<b>Sensor port</b>	1 port for a electrode/sensor with thread PG 13.5 or a PG 13.5 threaded plug head, diameter 12 mm and immersion length 120 mm
<b>Material</b>	stainless steel 1.4408
<b>Temperature range</b>	max. 150 °C (please note temperature limits for electrodes/sensors)
<b>Pressure</b>	max. 6 bar (please note pressure limits for electrodes/sensors)
<b>Process connection</b>	DN 20 internal screw connection G ¾ " (other pipe ports like flange or welding ports on request) mounting pre-eminently in a vertical medium pipe; electrode laterally up to 30° from vertical

## Sensortechnik Meinsberg GmbH

Quality System certified to DIN EN ISO 9001

Kurt-Schwabe-Straße 6  
D-04720 Ziegra-Knobelsdorf /GERMANY

Internet: [www.meinsberg.de](http://www.meinsberg.de)  
Tel. +49 34327 623-0  
Fax +49 34327 623-79

